

HONDA

INSTALLATION INSTRUCTIONS

Accessory

3.5 mm AUXILIARY CORD
P/N 08A87-MKC-A00

Application

GL1800/D/B/BD
GL1800DA (go to page 7)

Publication No.

MII 16426

Issue Date

January 2018

Honda Dealer: Please give a copy of these instructions to your customer.

PARTS LIST

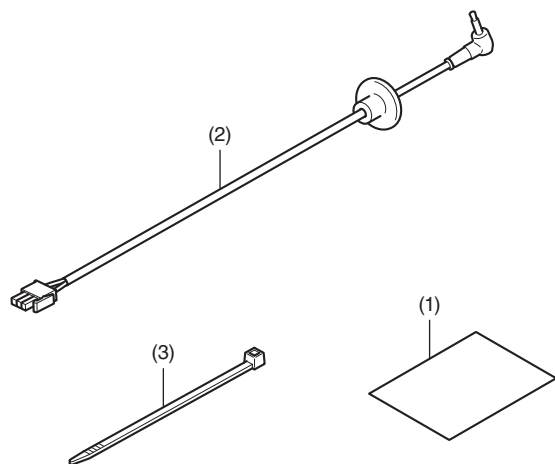

No.	Description	Qty
(1)	Installation Instructions URL	1
(2)	Auxiliary (AUX) cord	1
(3)	Wire tie	1

SUPPLIES REQUIRED

Snips

Ruler

Masking tape

Dish soap solution (Water:Dish soap / 100:1)

Shop towel

INSTALLATION

▲ CAUTION

- To prevent burns, allow the engine, exhaust system, radiator, etc., to cool before installing the accessory.

NOTE:

- Disconnect the negative (-) cable from the battery before installing this accessory.
- The memory of the clock will be erased when you disconnect the battery. Reset the clock after reconnecting the battery.
- Reinstall the removed parts on the motorcycle and make sure that the wires and harnesses are not pinched.
- Trim the excess ends off the wire ties after attaching them to the wire harnesses. Do not allow the cut part of the wire tie to interfere with another harness or brake hose.

- Open the left saddlebag lid as shown.

- Repeat on the right side.

<Left side>

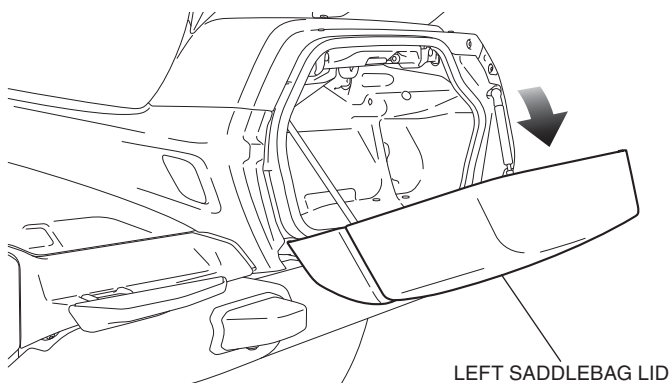

- Remove the left side cover as shown, and disconnect the negative (-) cable of the battery.

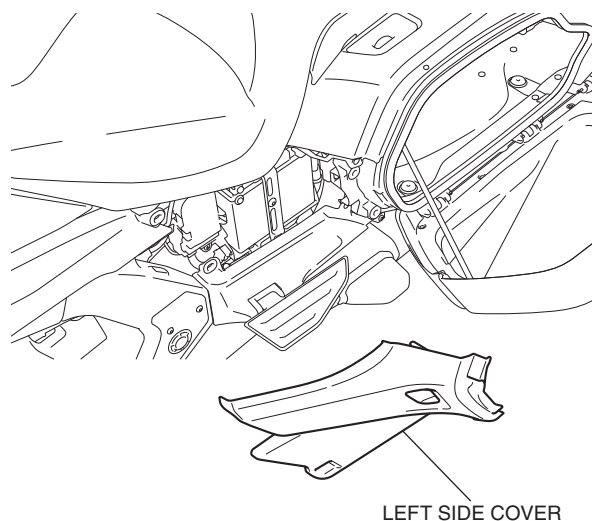

- Remove the right side cover in the same manner as the left side.

4. Remove the seat as shown.

- **Disconnect the connector for GL1800/D.**

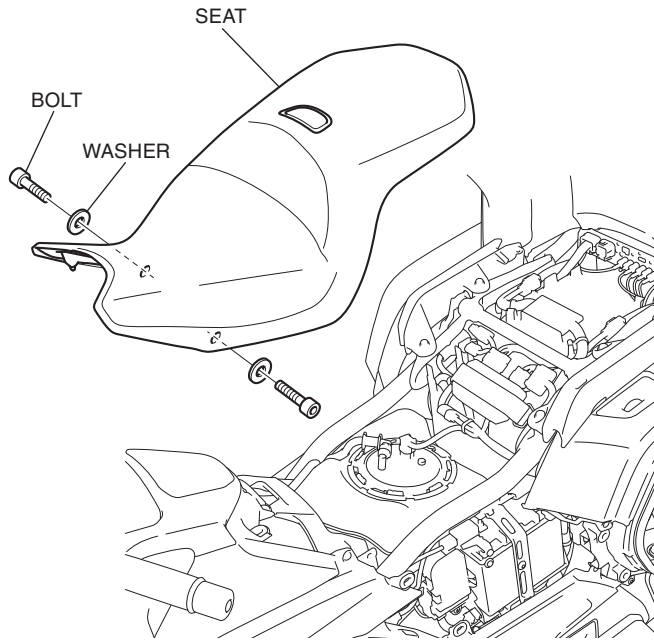

5. Fold down the left rear view mirror backward as shown.

<Left side>

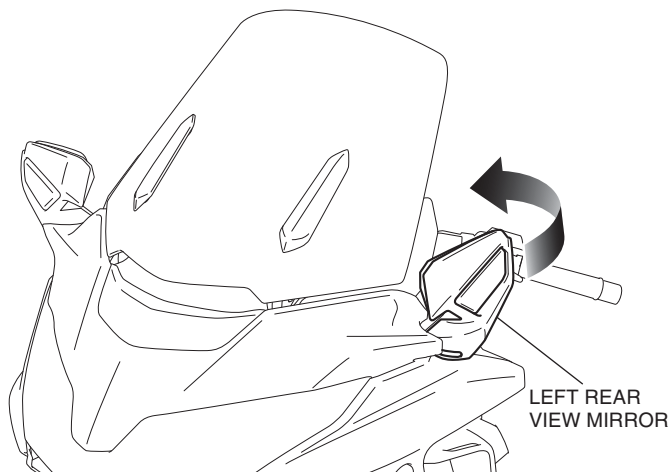

6. Remove the left mirror arm panel as shown.

<Left side>

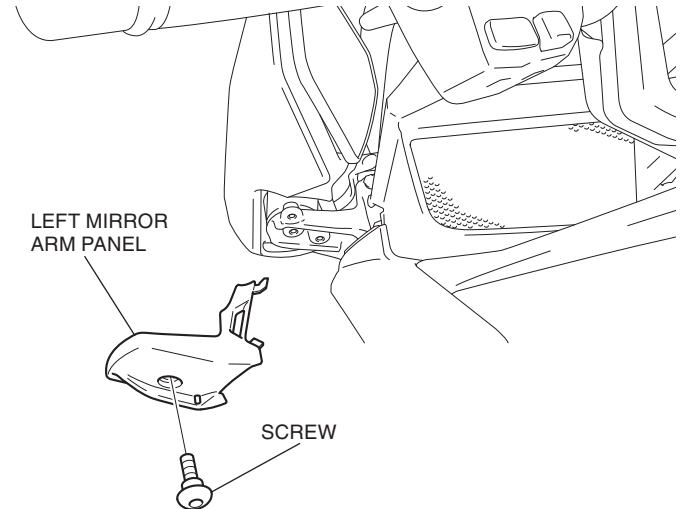

7. Remove the left rear view mirror as shown.

LEFT REAR VIEW MIRROR
Disconnect the connector.

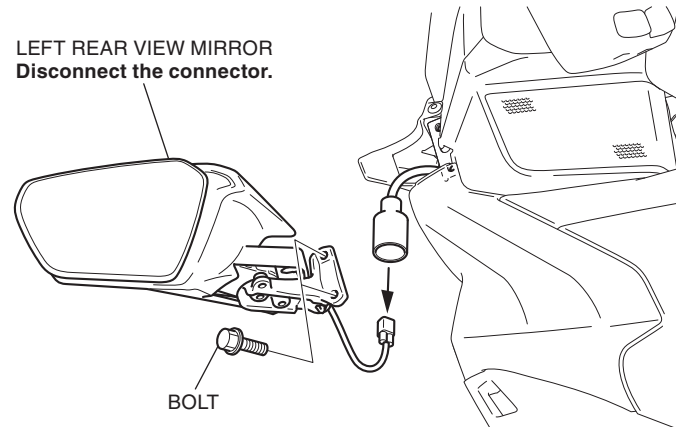

8. Remove the right mirror arm panel and right rear view mirror in the same manner as the left side.

9. Remove the screw as shown.

- **Repeat on the right side.**

<Left side>

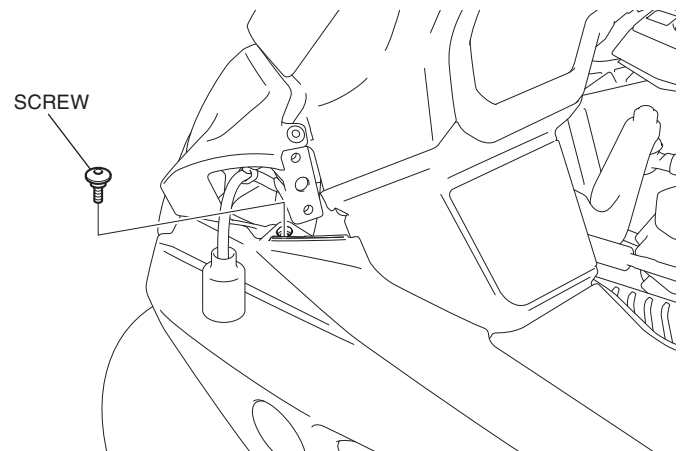

10. Remove the left deflector panel as shown.

<Left side>

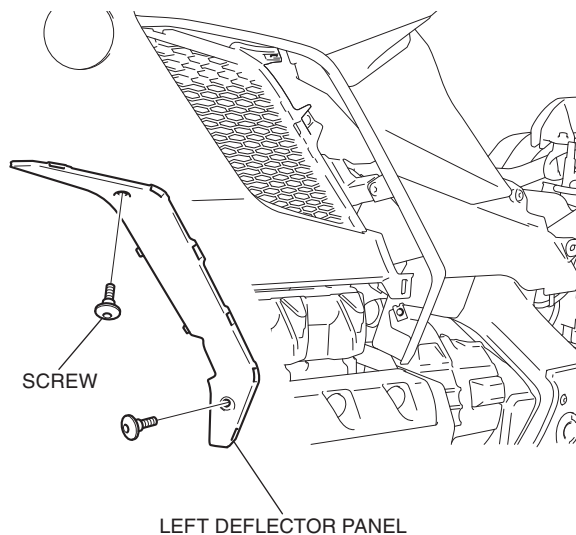

11. Remove the clip as shown.

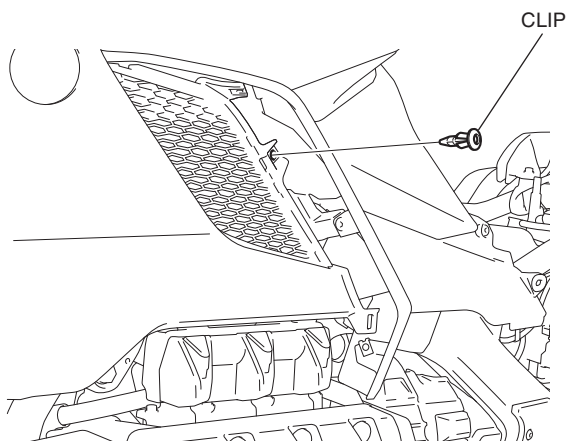

12. Remove the left inner cowl as shown.

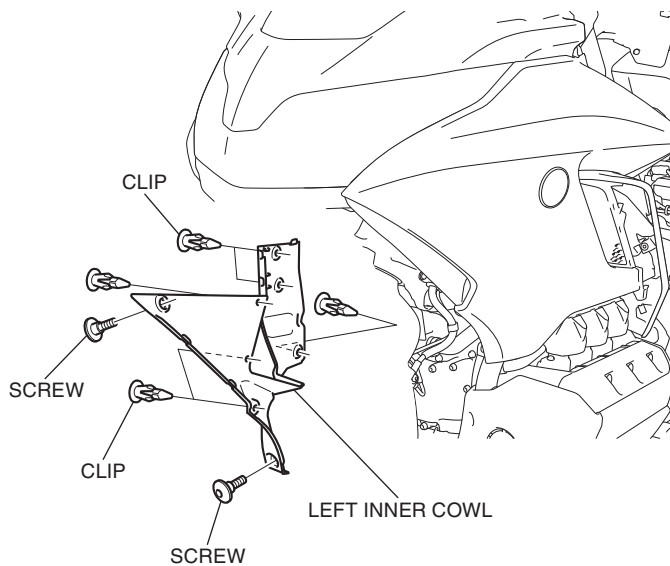

13. Remove the clip as shown.

<Left side>

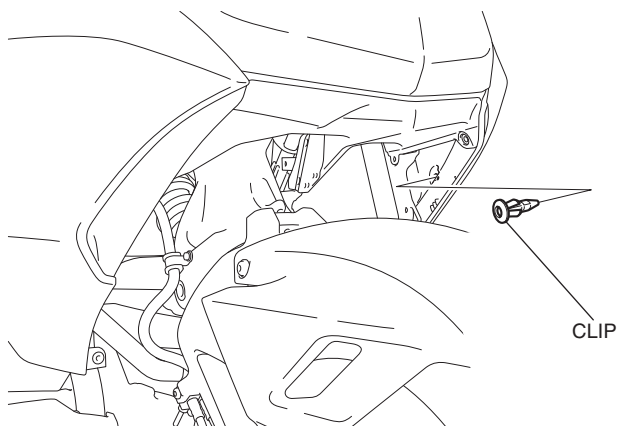

14. Remove the left middle cowl as shown.

<Left side>

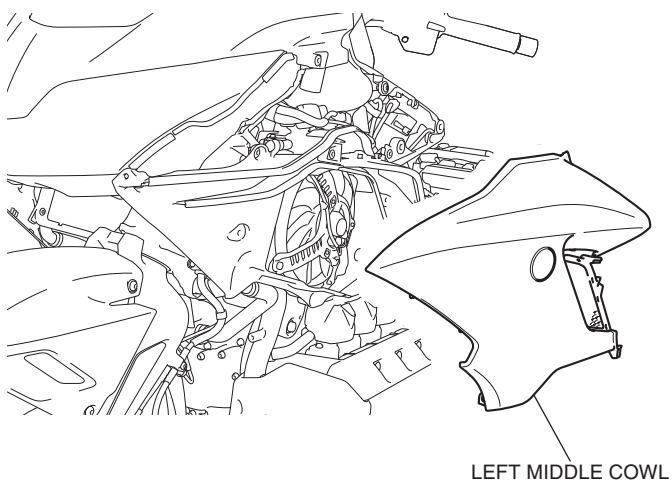

15. Remove the right deflector panel, right inner cowl and right middle cowl in the same manner as the left side.

16. Remove the parts as shown.

- Repeat on the right side.

<Left side>

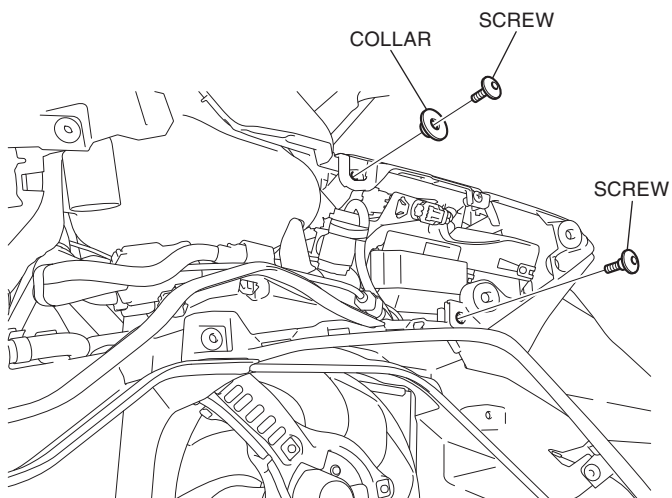

17. Remove the connector as shown.

<Right side>

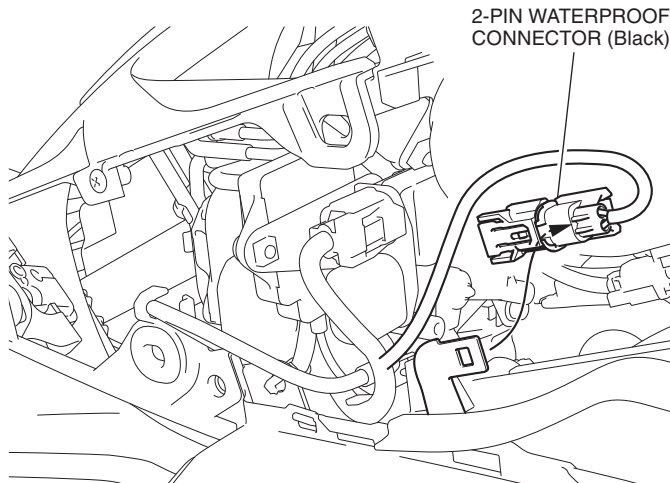

18. Remove the clip and disconnect the connector as shown.

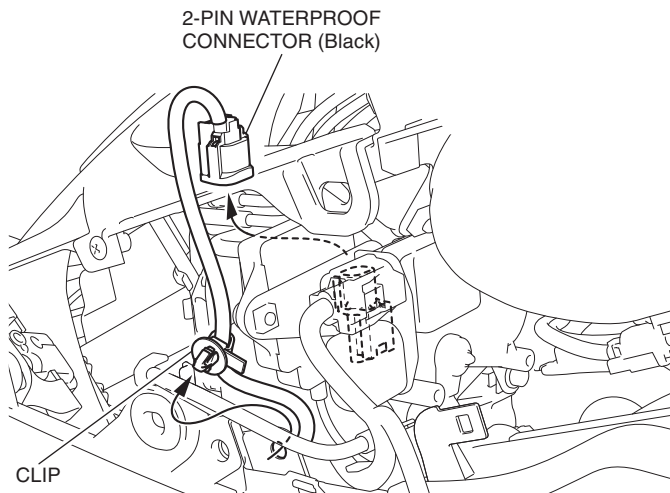

19. Remove the right outer air guide as shown.

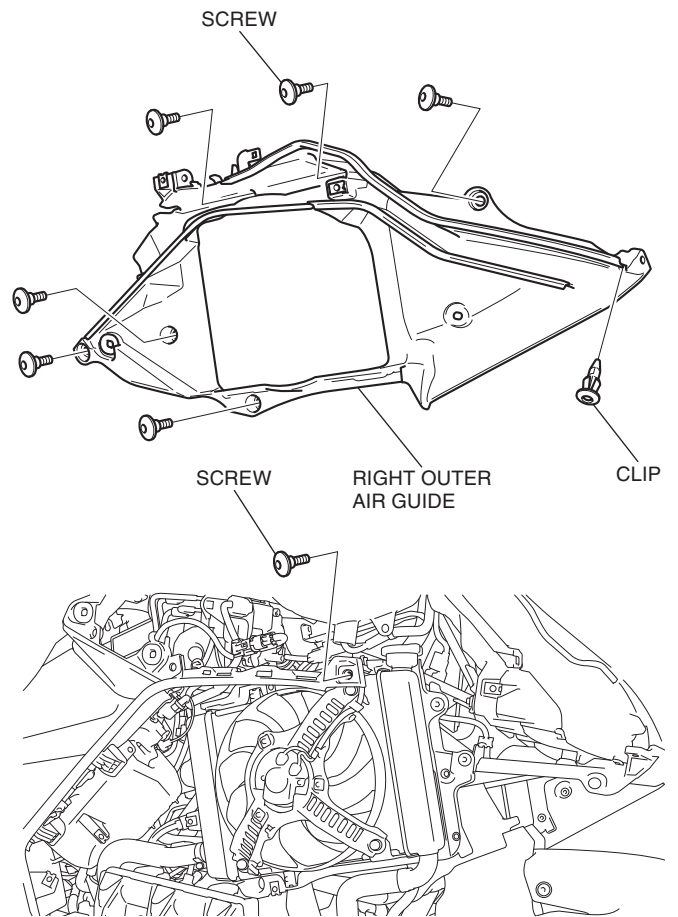

20. Remove the pocket cable as shown.

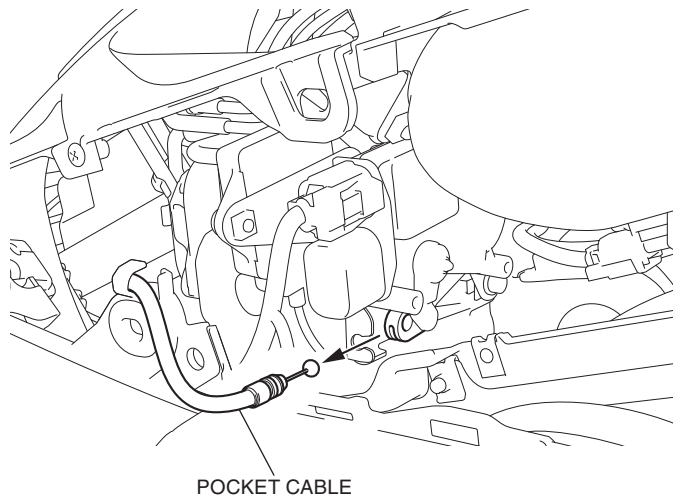

21. Remove the parts as shown.

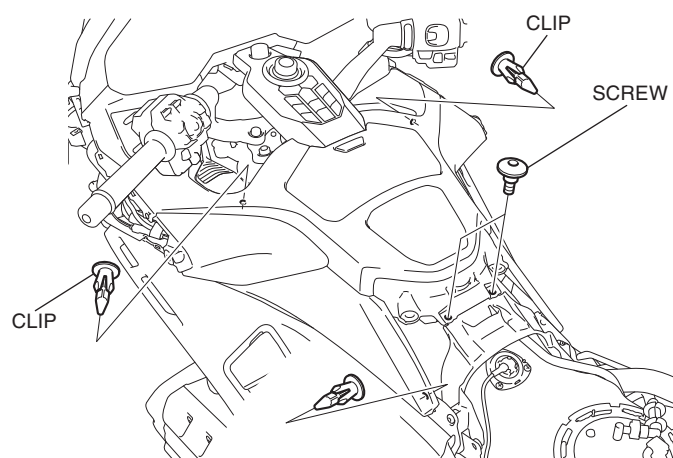

22. Remove the shelter as shown.

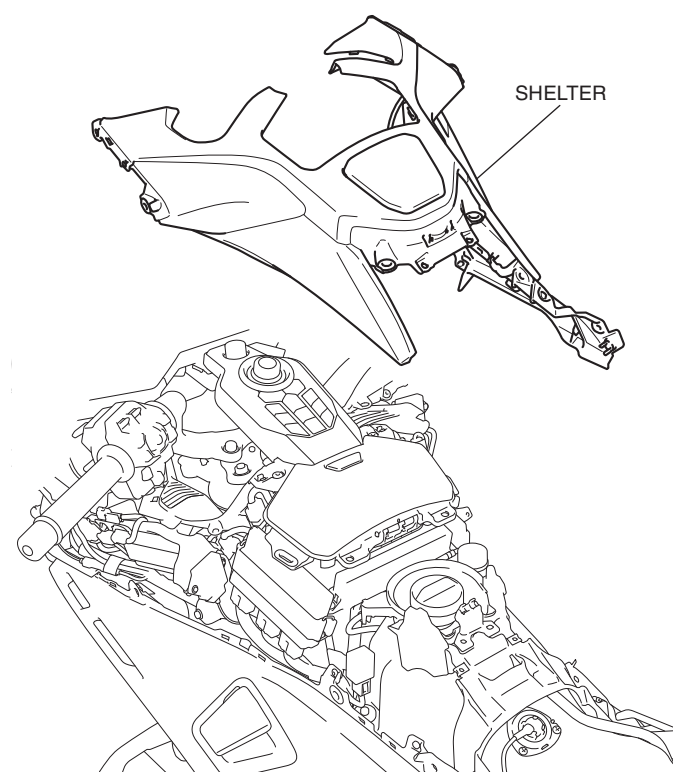

23. Open the pocket, remove the plug as shown.

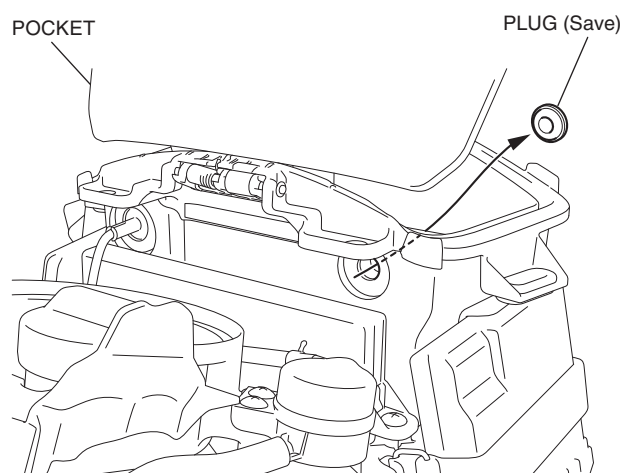

24. Secure the grommet to the AUX cord with the wire tie as shown.

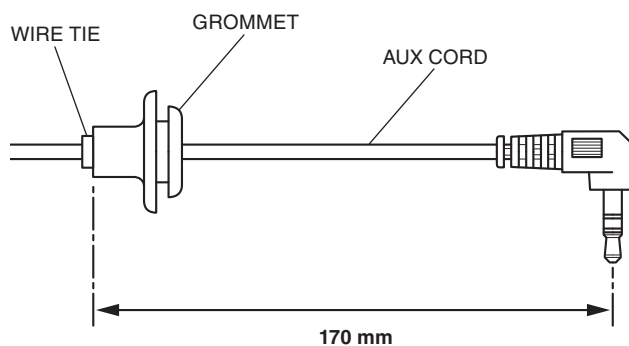

25. Attach the masking tape as shown.

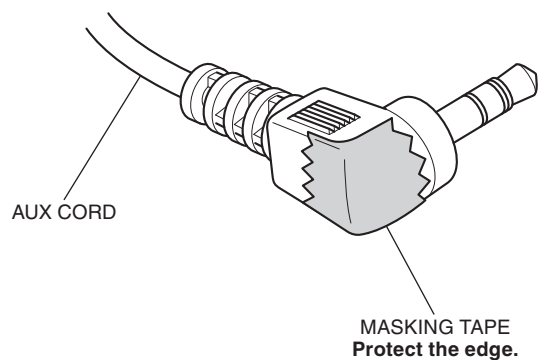

26. Apply dish soap solution to the position shown.

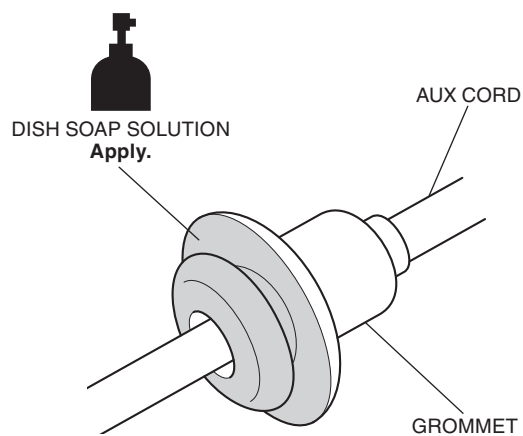

27. Route and install the AUX cord as shown.

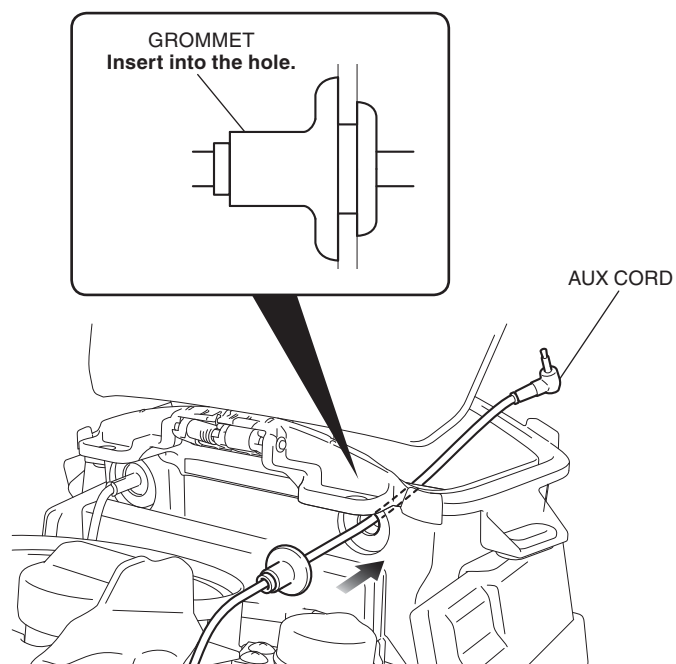

28. Remove the masking tape.

29. Route and connect the AUX cord as shown.

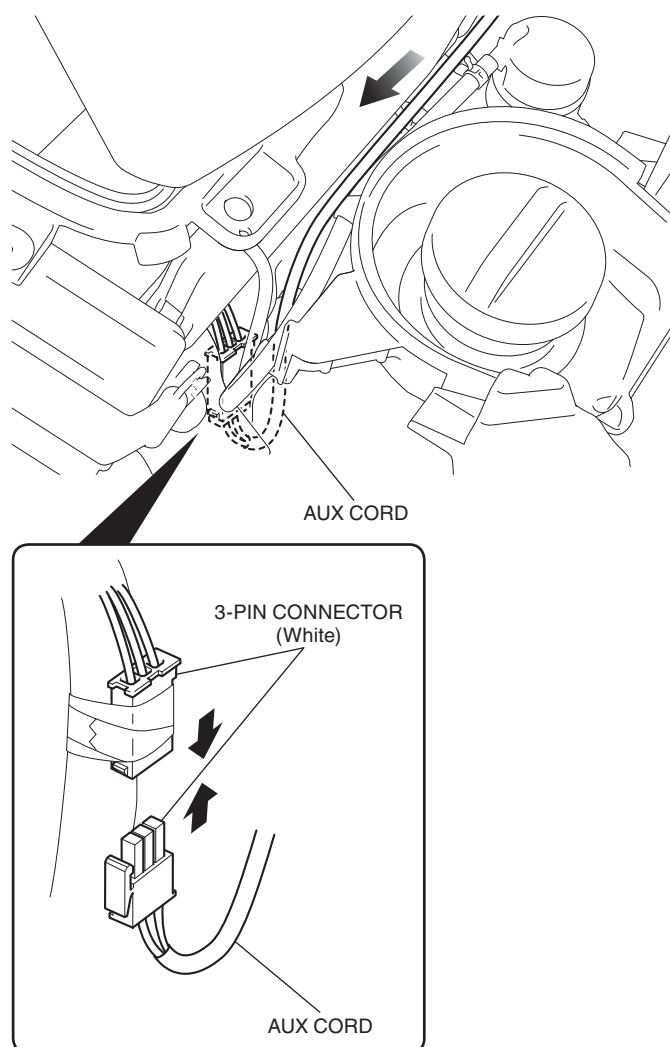

30. Install the motorcycle's parts in the reverse order of removal.

- **Confirm that any wire harness is not caught or too tight.**

31. Check the AUX, headlight and the other lights for proper operation.

HONDA

INSTALLATION INSTRUCTIONS

Accessory
3.5 mm AUXILIARY CORD
P/N 08A87-MKC-A00

Application
GL1800DA

Publication No.
MII 16426
Issue Date
January 2018

Honda Dealer: Please give a copy of these instructions to your customer.

PARTS LIST

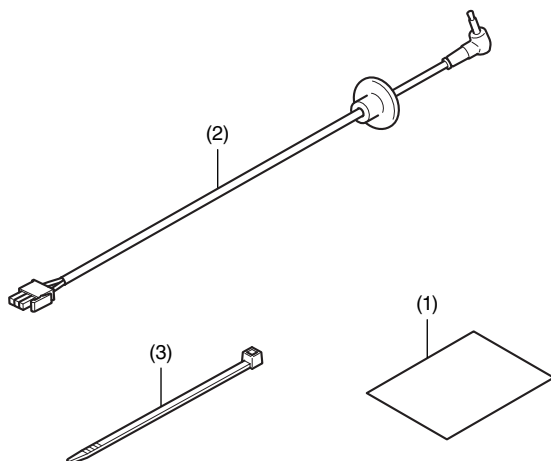

No.	Description	Qty
(1)	Installation Instructions URL	1
(2)	AUX cord	1
(3)	Wire tie	1

SUPPLIES REQUIRED

Electric drill
Drill bit (12 mm)
Ruler
Masking tape
Dish soap solution
(Water:dish soap / 100:1)
Shop towel
Side cutters

INSTALLATION

▲ CAUTION

- To prevent burns, allow the engine, exhaust system, radiator, etc., to cool before installing the accessory.

NOTE:

- Disconnect the negative (-) cable from the battery before installing this accessory.
- The clock memory will be erased when you disconnect the battery. Reset the clock after reconnecting the battery.
- Reinstall the removed parts on the motorcycle and make sure that the wires and harnesses are not pinched.
- Trim the excess ends off the wire ties after attaching them to the wire harnesses. Do not allow the cut part of the wire tie to interfere with another harness or brake hose.

- Open the left saddlebag lid as shown.

- Repeat on the right side.

<Left side>

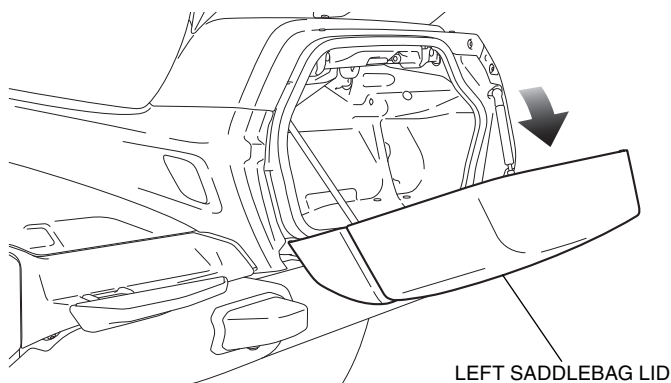

- Remove the left side cover as shown, and disconnect the negative (-) cable from the battery.

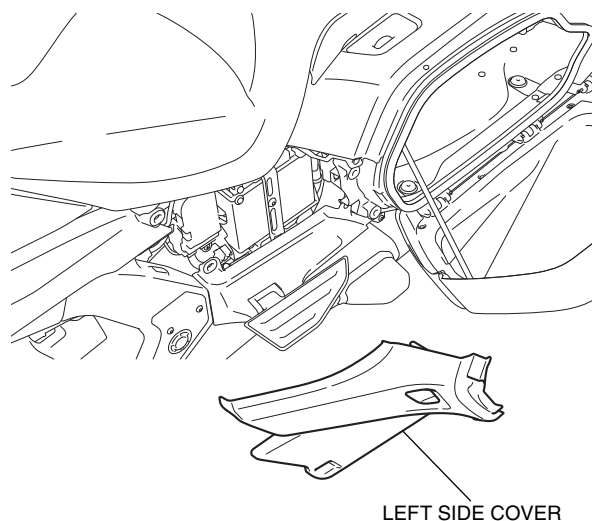

- Remove the right side cover in the same manner as the left side.

4. Remove the seat as shown.

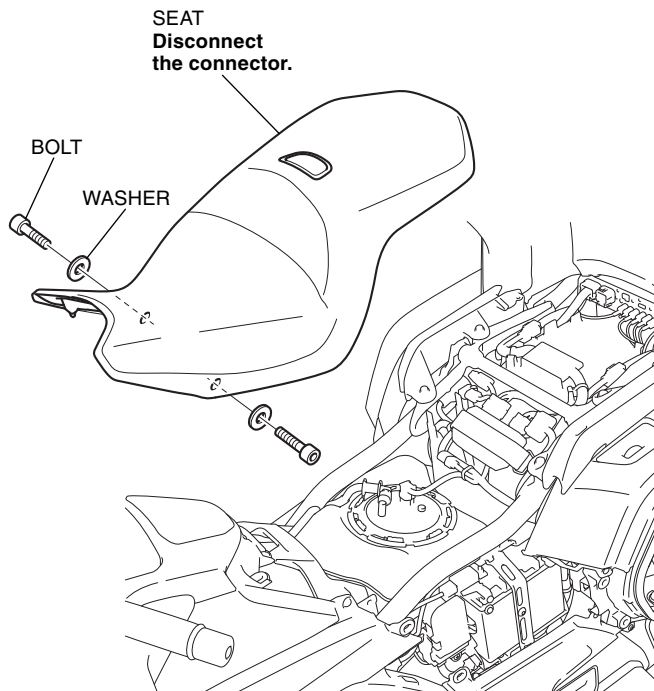

5. Remove the right and left passenger grips as shown.

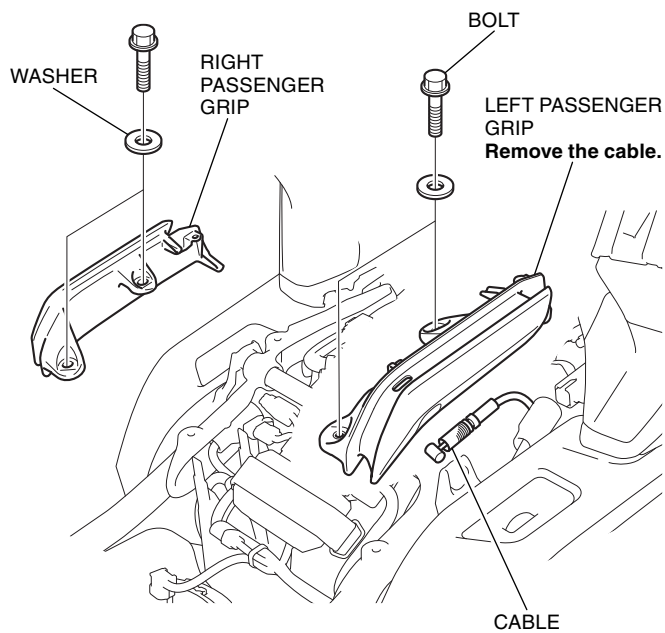

6. Open the rear trunk lid as shown.

- Refer to the Owner's Manual and use the emergency trunk cable to open the rear trunk lid.

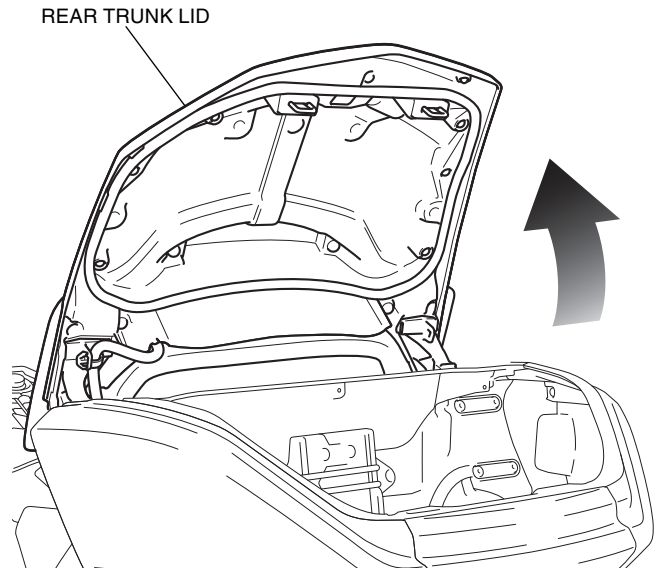

7. Disconnect the USB cord as shown.

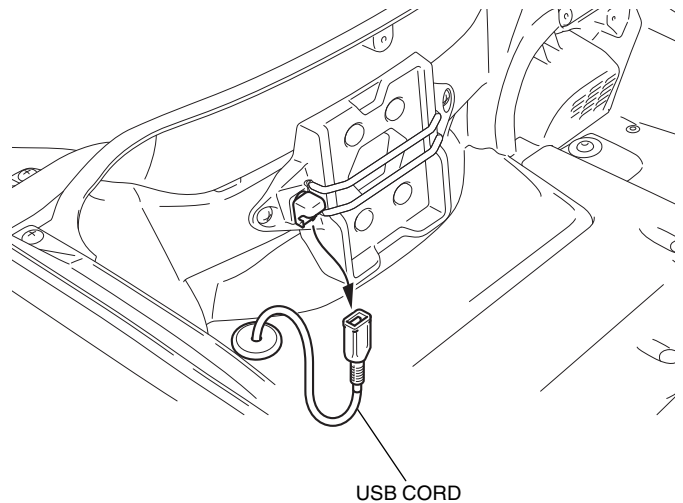

8. Remove the trunk holder as shown.

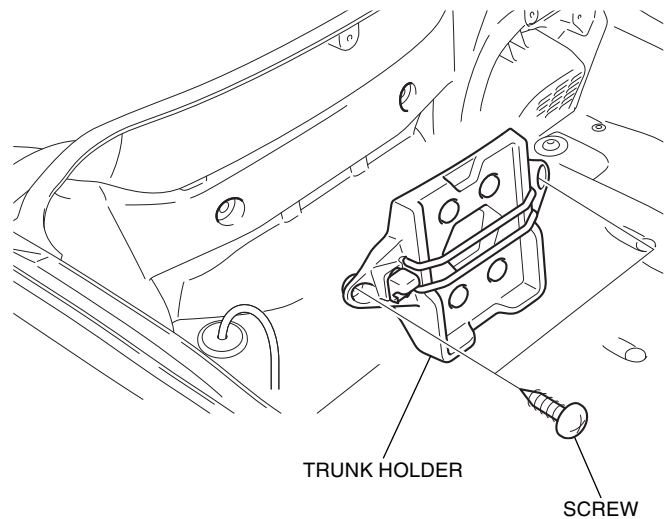

9. Remove the trunk front lower panel as shown.

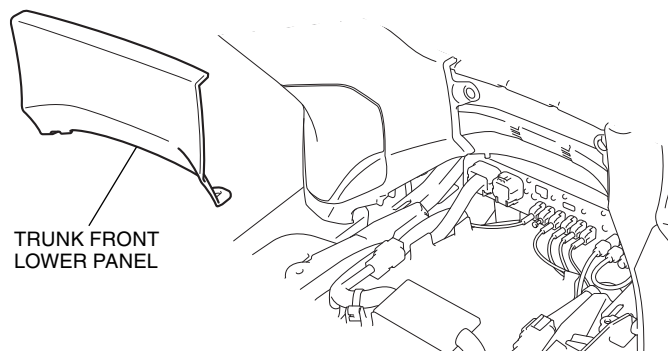

10. Remove the parts as shown.

- Repeat on the left side.

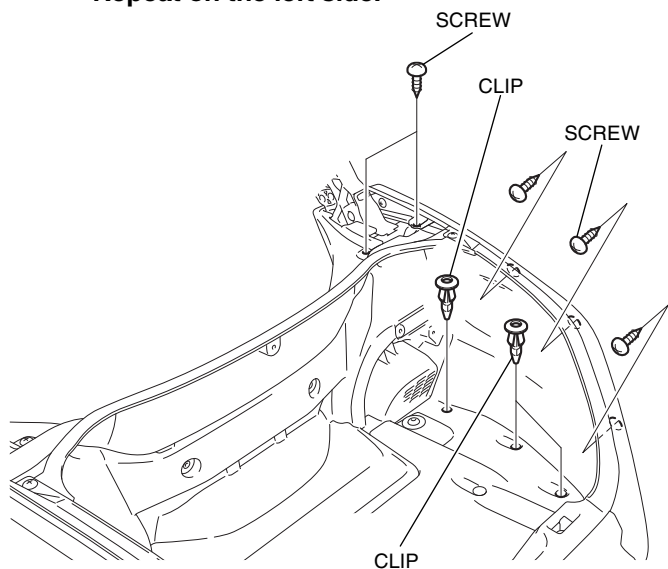

11. Remove the trunk right side cover as shown.

- Repeat on the left side.

<Right side>

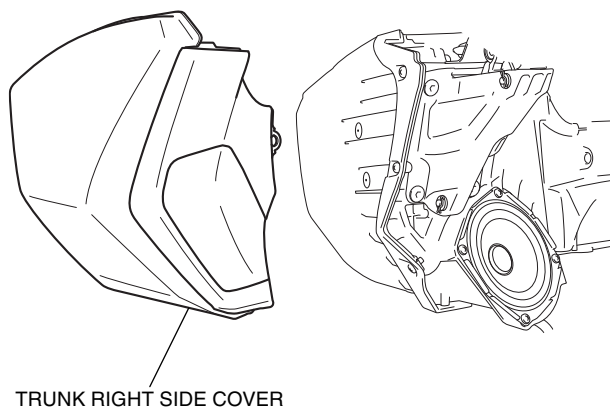

12. Disconnect the connector as shown.

<Left side>

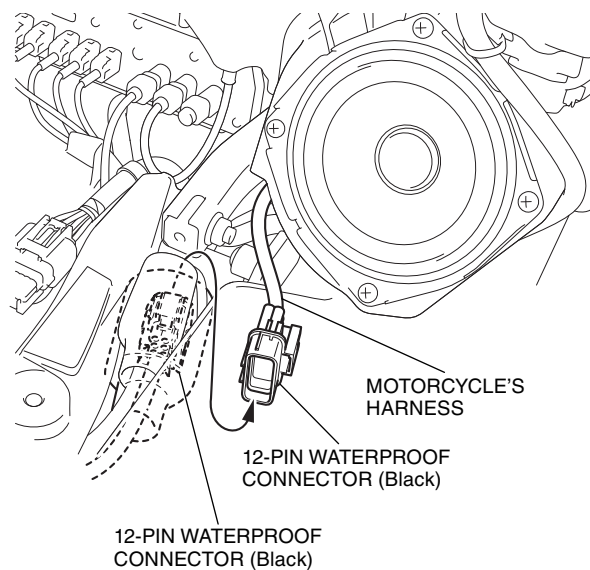

13. Disconnect the USB cord as shown.

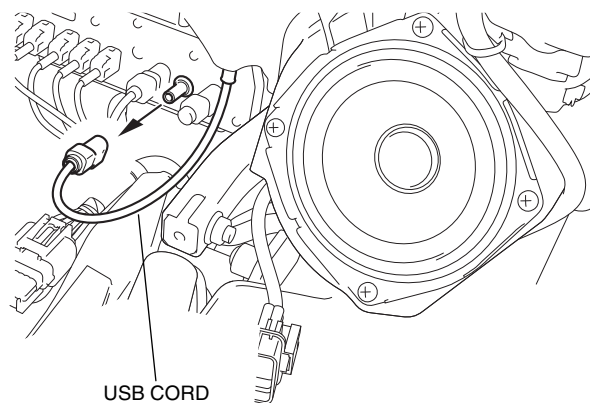

14. Disconnect the connector as shown.

<Right side>

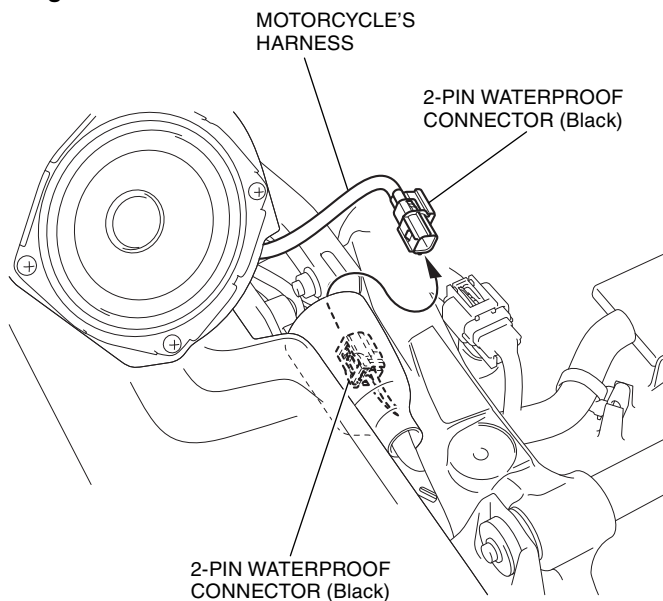

15. Remove the trunk center lower cover as shown.

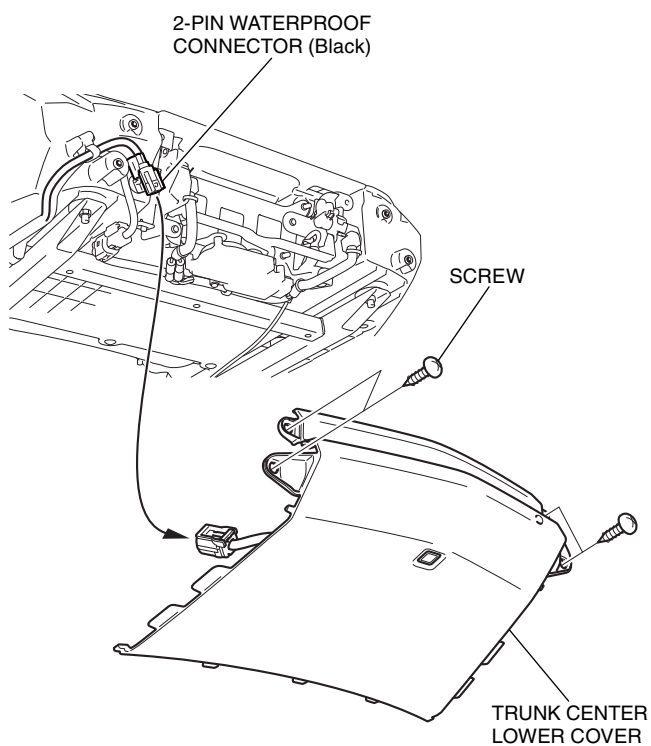

16. Disconnect the trunk catch harness as shown.

Remove the emergency trunk cable as shown.

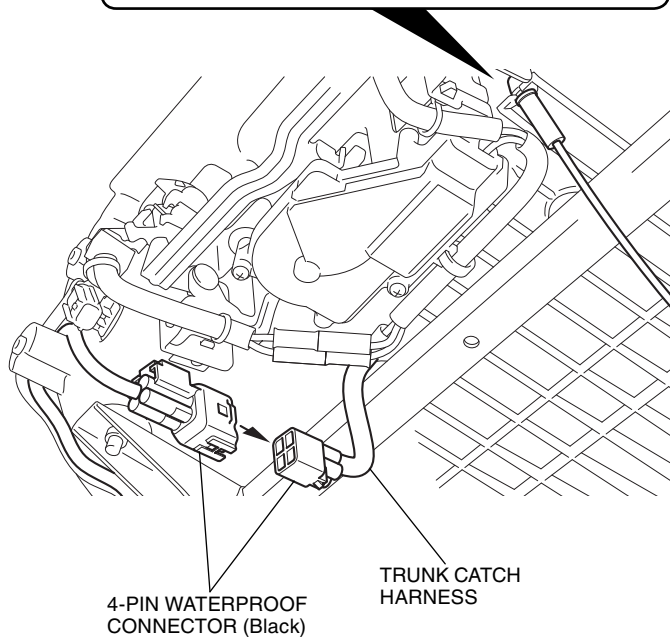
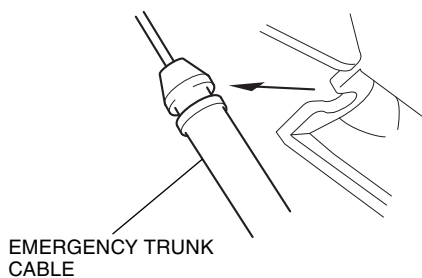

17. Remove the trunk catch as shown.

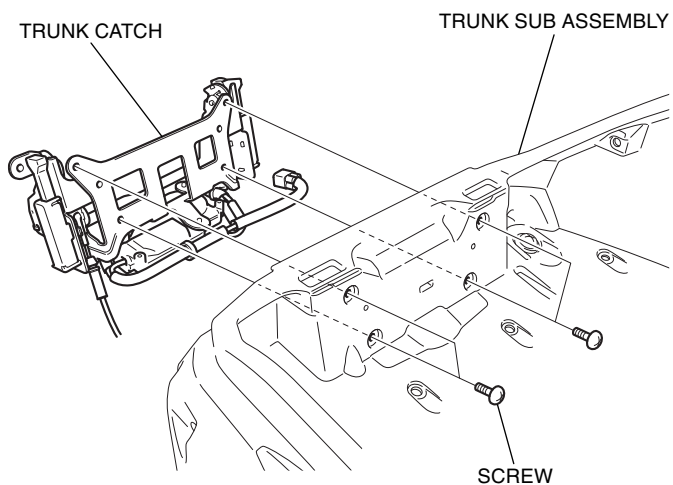

18. Remove the emergency trunk cable as shown.

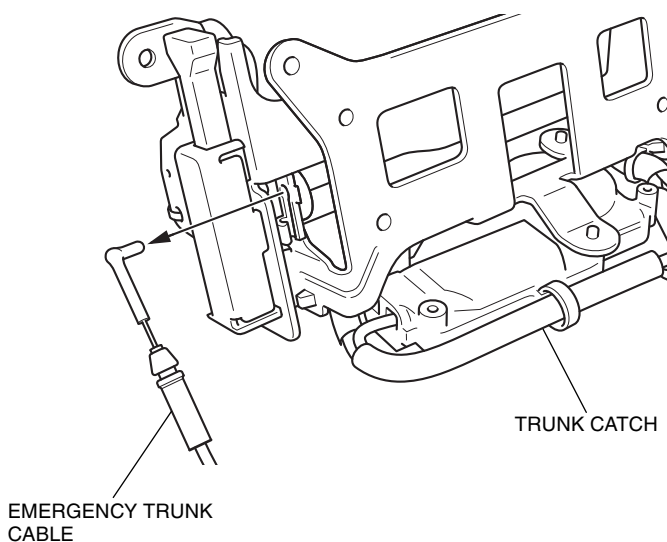

19. Remove the hardware as shown.

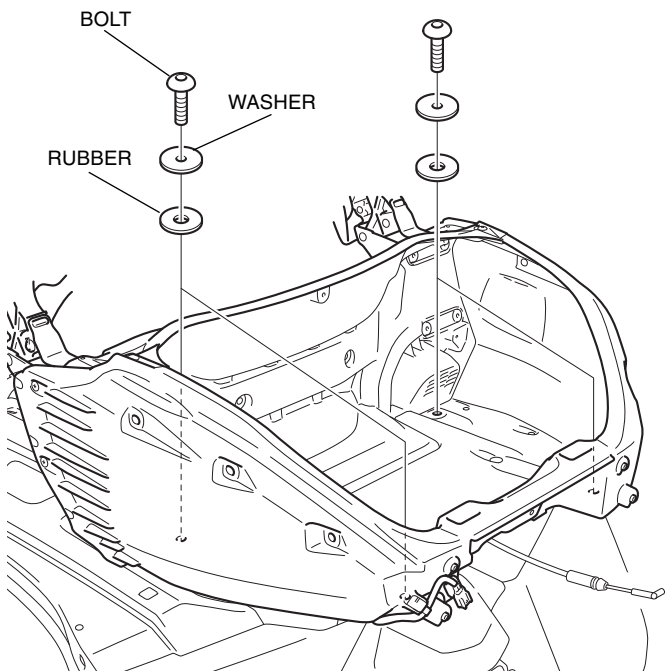

20. Remove the rear trunk and collars as shown.

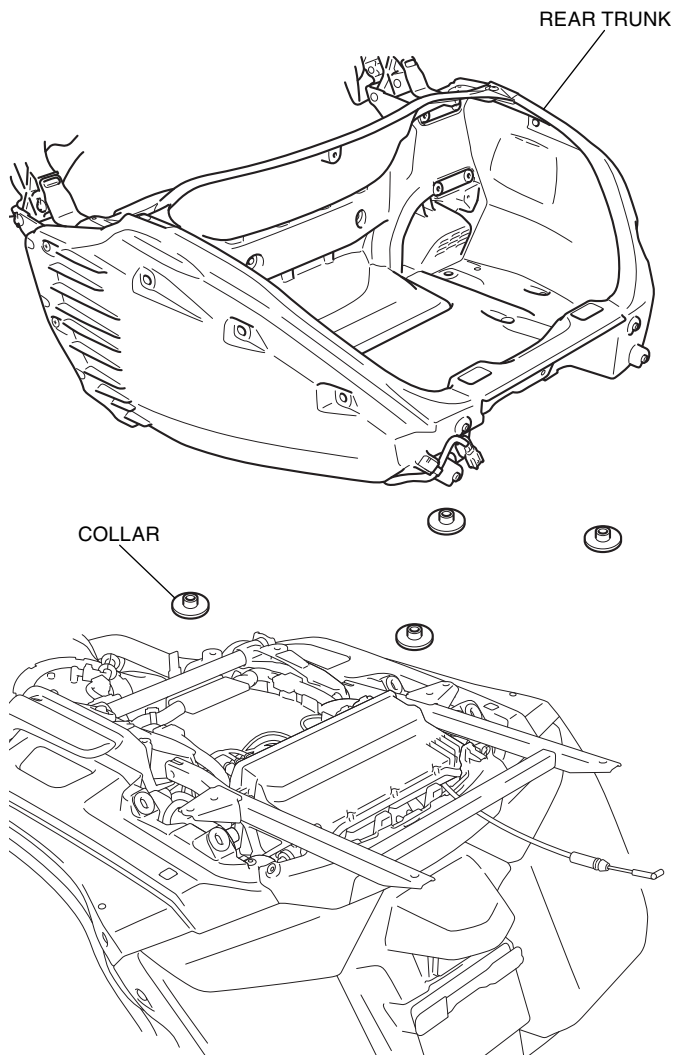

21. Drill at the marked line of the rear trunk as shown.

- Drill hole at the center of the marked line.
- Remove the any burrs from the edge of the hole.

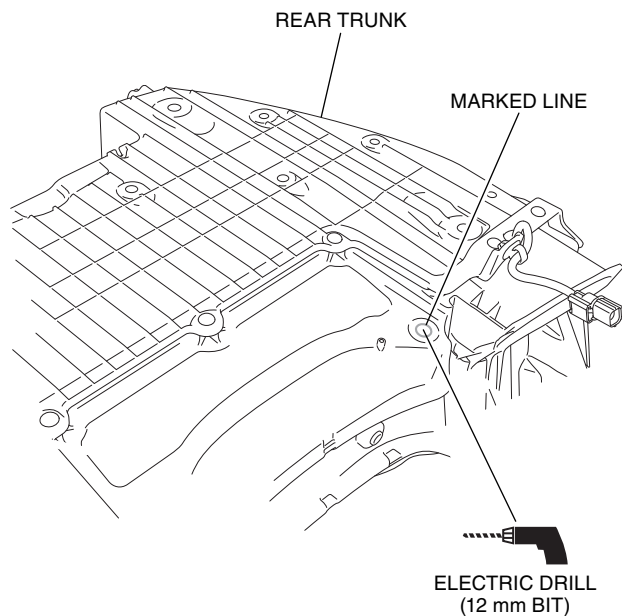

22. Secure the AUX cord grommet with the wire tie at the distance shown.

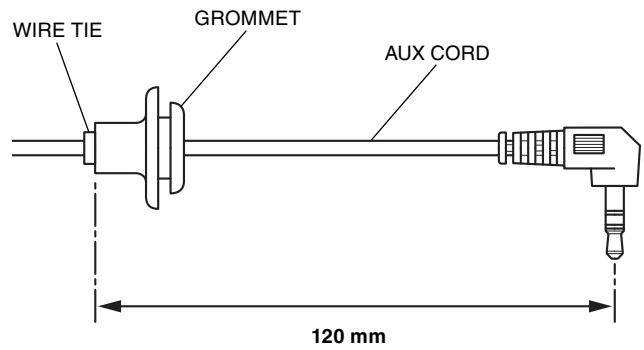

23. Attach the masking tape as shown.

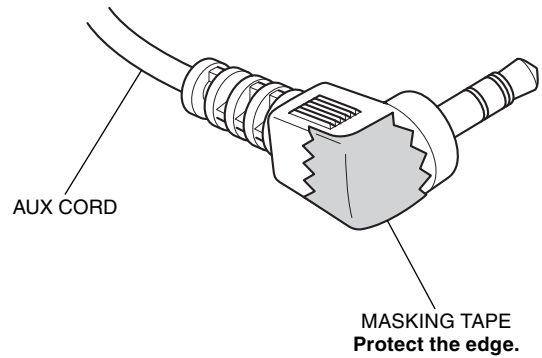

24. Apply dish soap solution to the position shown.

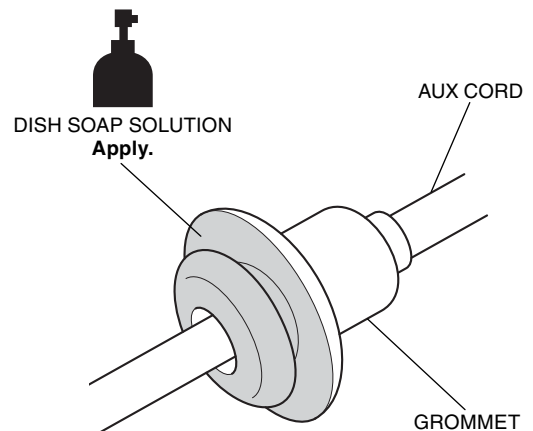

25. Route and install the AUX cord as shown.

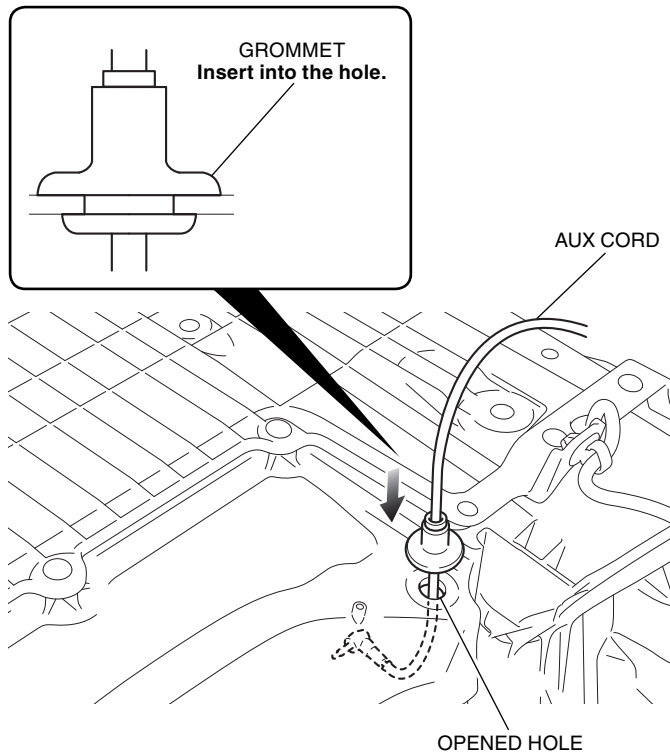

26. Remove the masking tape.

27. Install the rear trunk in the reverse order of removal.

28. Route the AUX cord as shown.

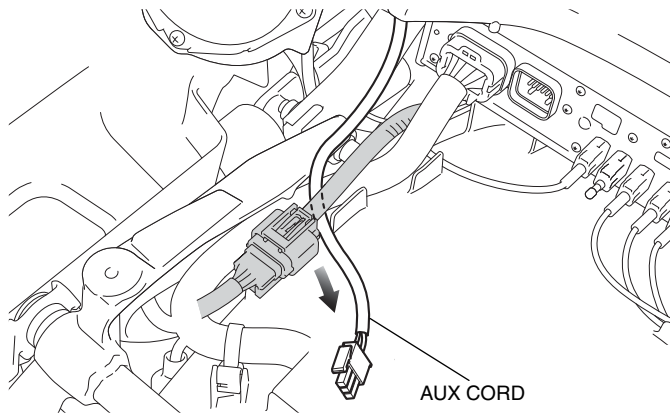

29. Move the boots as shown.

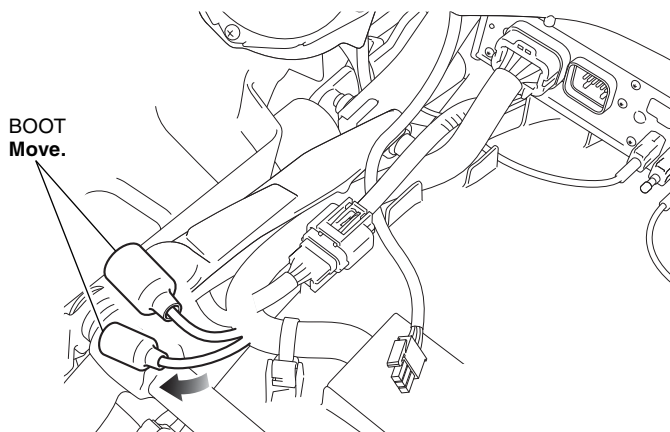

30. Connect the AUX cord as shown.

- **Return the boots to the original position.**

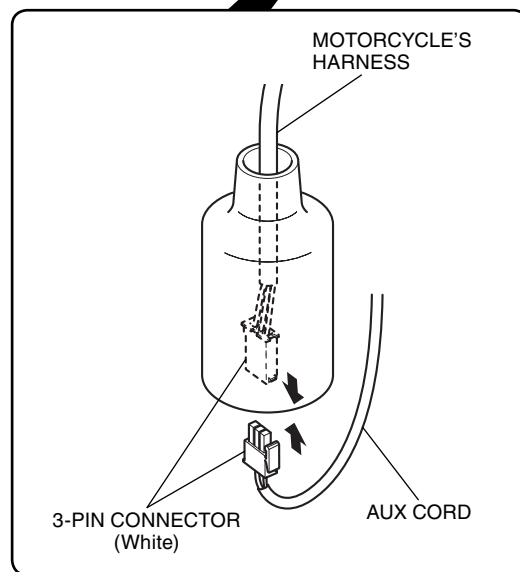
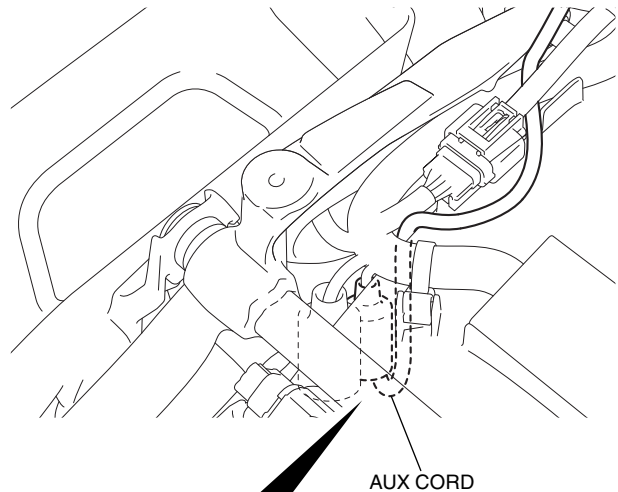

31. Install the motorcycle's parts in the reverse order of removal.

- **Confirm that any wire harness is not caught or too tight.**

32. Check the AUX, headlight and the other lights for proper operation.